

TYPE 1 - FIXED X FIXED FLANGE (ANSI)

T-321 STAINLESS STEEL BELLOWS & FLEX
 125-150# ANSI FLANGE INLET, A-36 STEEL
 125-150# ANSI FLANGE OUTLET, A-36 STEEL

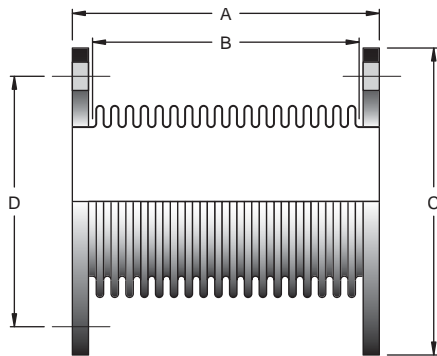

TYPE 1L - FIXED X FIXED FLANGE (ANSI)

T-321 S/S BELLOWS / FLEX WITH INTERNAL FLOW LINER
 125-150# ANSI FLANGE INLET, A-36 STEEL
 125-150# ANSI FLANGE OUTLET, A-36 STEEL

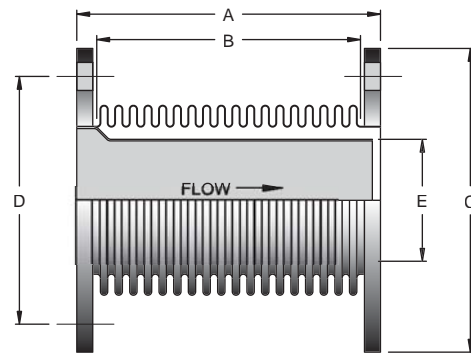

TYPE 1 - MULTI-PLY BELLOWS

SIZE	A	B	C	D	HOLES	DIA	PART NO.
3"	10.00	9.00	7.50	6.00	4	0.75	1M0300-10
3-1/2"	10.00	9.00	8.50	7.00	8	0.75	1M0350-10
4"	10.00	9.00	9.00	7.50	8	0.75	1M0400-10
5"	10.00	9.00	10.00	8.50	8	0.88	1M0500-10
6"	10.00	9.00	11.00	9.50	8	0.88	1M0600-10
8"	10.00	9.00	13.50	11.75	8	0.88	1M0800-10
10"	10.00	9.00	16.00	14.25	12	1.00	1M1000-10
12"	10.00	9.00	19.00	17.00	12	1.00	1M1200-10
14"	10.00	9.00	21.00	18.75	12	1.13	1M1400-10
16"	10.00	9.00	23.50	21.25	16	1.13	1M1600-10
18"	10.00	9.00	25.50	22.75	16	1.25	1M1800-10
20"	10.00	9.00	27.50	25.00	20	1.25	1M2000-10
22"	10.00	9.00	29.50	27.25	20	1.38	1M2200-10
24"	10.00	9.00	32.00	29.50	20	1.38	1M2400-10

TYPE 1L - MULTI-PLY BELLOWS WITH LINER

SIZE	I.D.	A	B	C	D	E	PART NO.
3"	3.50	10.00	9.00	7.50	6.00	2.88	1M0300-10L
3-1/2"	4.00	10.00	9.00	8.50	7.00	3.38	1M0350-10L
4"	4.50	10.00	9.00	9.00	7.50	3.88	1M0400-10L
5"	5.56	10.00	9.00	10.00	8.50	4.75	1M0500-10L
6"	6.63	10.00	9.00	11.00	9.50	5.75	1M0600-10L
8"	8.63	10.00	9.00	13.50	11.75	7.75	1M0800-10L
10"	10.75	10.00	9.00	16.00	14.25	9.88	1M1000-10L
12"	12.75	10.00	9.00	19.00	17.00	11.88	1M1200-10L
14"	14.00	10.00	9.00	21.00	18.75	13.00	1M1400-10L
16"	16.00	10.00	9.00	23.50	21.25	15.00	1M1600-10L
18"	18.00	10.00	9.00	25.50	22.75	17.00	1M1800-10L
20"	20.00	10.00	9.00	27.50	25.00	19.00	1M2000-10L
22"	22.00	10.00	9.00	29.50	27.25	21.00	1M2200-10L
24"	24.00	10.00	9.00	32.00	29.50	23.00	1M2400-10L

TYPE 1 - SINGLE-PLY BELLOWS

SIZE	A	B	C	D	HOLES	DIA	PART NO.
3"	10.00	9.00	7.50	6.00	4	0.75	1S0300-10
3-1/2"	10.00	9.00	8.50	7.00	8	0.75	1S0350-10
4"	10.00	9.00	9.00	7.50	8	0.75	1S0400-10
5"	10.00	9.00	10.00	8.50	8	0.88	1S0500-10
6"	10.00	9.00	11.00	9.50	8	0.88	1S0600-10
8"	10.00	9.00	13.50	11.75	8	0.88	1S0800-10
10"	10.00	9.00	16.00	14.25	12	1.00	1S1000-10
12"	10.00	9.00	19.00	17.00	12	1.00	1S1200-10
14"	10.00	9.00	21.00	18.75	12	1.13	1S1400-10
16"	10.00	9.00	23.50	21.25	16	1.13	1S1600-10
18"	10.00	9.00	25.50	22.75	16	1.25	1S1800-10
20"	10.00	9.00	27.50	25.00	20	1.25	1S2000-10
22"	10.00	9.00	29.50	27.25	20	1.38	1S2200-10
24"	10.00	9.00	32.00	29.50	20	1.38	1S2400-10

TYPE 1L - SINGLE-PLY BELLOWS WITH LINER

SIZE	I.D.	A	B	C	D	E	PART NO.
3"	3.50	10.00	9.00	7.50	6.00	2.88	1S0300-10L
3-1/2"	4.00	10.00	9.00	8.50	7.00	3.38	1S0350-10L
4"	4.50	10.00	9.00	9.00	7.50	3.88	1S0400-10L
5"	5.56	10.00	9.00	10.00	8.50	4.75	1S0500-10L
6"	6.63	10.00	9.00	11.00	9.50	5.75	1S0600-10L
8"	8.63	10.00	9.00	13.50	11.75	7.75	1S0800-10L
10"	10.75	10.00	9.00	16.00	14.25	9.88	1S1000-10L
12"	12.75	10.00	9.00	19.00	17.00	11.88	1S1200-10L
14"	14.00	10.00	9.00	21.00	18.75	13.00	1S1400-10L
16"	16.00	10.00	9.00	23.50	21.25	15.00	1S1600-10L
18"	18.00	10.00	9.00	25.50	22.75	17.00	1S1800-10L
20"	20.00	10.00	9.00	27.50	25.00	19.00	1S2000-10L
22"	22.00	10.00	9.00	29.50	27.25	21.00	1S2200-10L
24"	24.00	10.00	9.00	32.00	29.50	23.00	1S2400-10L

TYPE 1 - FLEX HOSE

SIZE	A	B	C	D	HOLES	DIA	PART NO.
3"	18.00	17.00	7.50	6.00	4	0.75	1F0300-18
3-1/2"	18.00	17.00	8.50	7.00	8	0.75	1F0350-18
4"	18.00	17.00	9.00	7.50	8	0.75	1F0400-18
5"	18.00	17.00	10.00	8.50	8	0.88	1F0500-18
6"	18.00	17.00	11.00	9.50	8	0.88	1F0600-18
8"	18.00	17.00	13.50	11.75	8	0.88	1F0800-18
10"	18.00	17.00	16.00	14.25	12	1.00	1F1000-18
12"	18.00	17.00	19.00	17.00	12	1.00	1F1200-18
14"	18.00	17.00	21.00	18.75	12	1.13	1F1400-18
16"	18.00	17.00	23.50	21.25	16	1.13	1F1600-18
18"	18.00	17.00	25.50	22.75	16	1.25	1F1800-18

OPTIONS:

- Longer / Shorter Lengths
- Increasing / Reducing Flanges
- Special Drilled / Metric Flanges
- Cummins and Detroit Flanges
- T-304 Stainless Steel Flanges
- Inconel 625 Bellows

NOTES:

- T-321 Stainless Steel Vanstone (Standard).
- Standard Flow Liner Diameter "E" Limits Lateral Offset to 3/8" For Increased Offset "E" Must Be Reduced.
- Internal Flow Liners are Required if Flow Conditions are Equal or Greater Than the Following:
 - 6" and Under (Gas / Steam) - 4ft/sec/inch of Diameter.
 - 8" and Over (Gas / Steam) - 25ft/sec.

See pages 27-29 for bellows and flex hose specifications.