

WAWKESHA FACTORY REPLACEMENT BELLOWS

TYPE 41W - FLANGE X 20 DEG LIP FLANGE

T-321 STAINLESS STEEL BELLOWS
 T-321 S/S WAWKESHA LIP FLANGE
 125-150# ANSI FLANGE OUTLET, A-36 STEEL

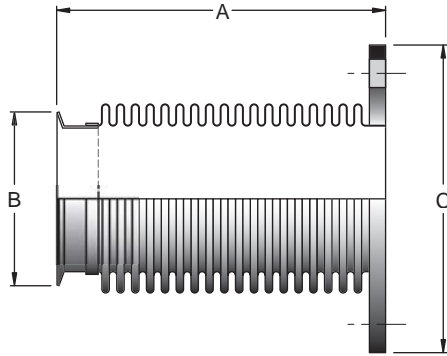

SIZE	A	B	C	MULTI-PLY	SINGLE-PLY
5"	8.00	6.13	10.00	41M0500-8W	41S0500-8W
6"	8.00	6.75	11.00	41M0600-8W	41S0600-8W
8"	8.00	9.00	13.50	41M0800-8W	41S0800-8W
12"	8.00	13.00	19.00	41M1200-8W	41S1200-8W
14"	8.00	15.13	21.00	41M1400-8W	41S1400-8W

TYPE 41LW - FLANGE X 20 DEG LIP FLANGE

T-321 STAINLESS STEEL BELLOWS
 T-321 S/S WAWKESHA LIP FLANGE
 125-150# ANSI FLANGE OUTLET, A-36 STEEL
 T-321 S/S FLOW LINER

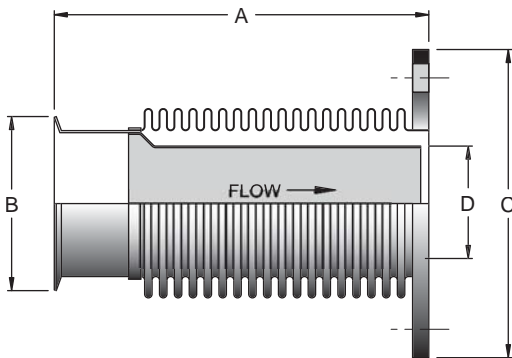

SIZE	A	B	C	D	MULTI-PLY	SINGLE-PLY
5"	8.00	6.13	10.00	4.38	41M0500-8LW	41S0500-8LW
6"	8.00	6.75	11.00	5.38	41M0600-8LW	41S0600-8LW
8"	8.00	9.00	13.50	7.38	41M0800-8LW	41S0800-8LW
12"	8.00	13.00	19.00	11.38	41M1200-8LW	41S1200-8LW
14"	8.00	15.13	21.00	13.38	41M1400-8LW	41S1400-8LW

OPTIONS:

- Longer / Shorter Lengths
- Increasing / Reducing Flanges
- Special Drilled / Metric Flanges
- T-304 Stainless Steel Flanges
- Inconel 625 Bellows

TYPE 42 - FIXED X FIXED (ANSI)

T-321 STAINLESS STEEL BELLOWS
 125-150# ANSI FLANGE INLET, A-36 STEEL
 125-150# ANSI FLANGE OUTLET, A-36 STEEL

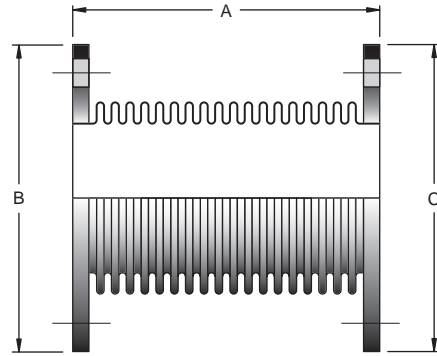

SIZE	A	B	C	MULTI-PLY	SINGLE-PLY
5"	8.00	10.00	10.00	42M0500-8	42S0500-8
6"	8.00	11.00	11.00	42M0600-8	42S0600-8
8"	8.00	13.50	13.50	42M0800-8	42S0800-8
10"	8.00	16.00	16.00	42M1000-8	42S1000-8
12"	8.00	19.00	19.00	42M1200-8	42S1200-8
14"	8.00	21.00	21.00	42M1400-8	42S1400-8

TYPE 42L - FIXED X FIXED (ANSI)

T-321 STAINLESS STEEL BELLOWS
 125-150# ANSI FLANGE INLET, A-36 STEEL
 125-150# ANSI FLANGE OUTLET, A-36 STEEL
 T-321 S/S FLOW LINER

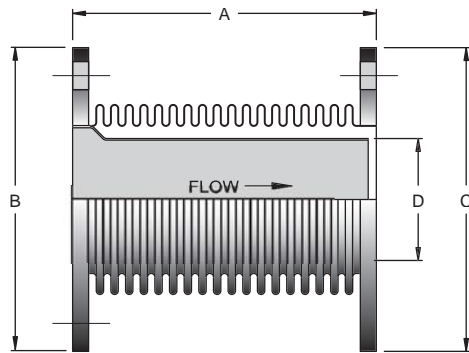

SIZE	A	B	C	D	MULTI-PLY	SINGLE-PLY
5"	8.00	10.00	10.00	4.38	42M0500-8L	42S0500-8L
6"	8.00	11.00	11.00	5.38	42M0600-8L	42S0600-8L
8"	8.00	13.50	13.50	7.38	42M0800-8L	42S0800-8L
10"	8.00	16.50	16.00	9.38	42M1000-8L	42S1000-8L
12"	8.00	19.00	19.00	11.38	42M1200-8L	42S1200-8L
14"	8.00	21.00	21.00	13.38	42M1400-8L	42S1400-8L

NOTES:

- For Optional "Venturi", Consult the Factory.
- Standard Flow Liner Diameter "D" Limits Lateral Offset to 3/8" For Increased Offset "D" Must Be Reduced.
- Internal Flow Liners are Required if Flow Conditions are Equal or Greater Than the Following:
 - 6" and Under (Gas / Steam) - 4ft/sec/inch of Diameter.
 - 8" and Over (Gas / Steam) - 25ft/sec.