

VIBRATION ISOLATORS

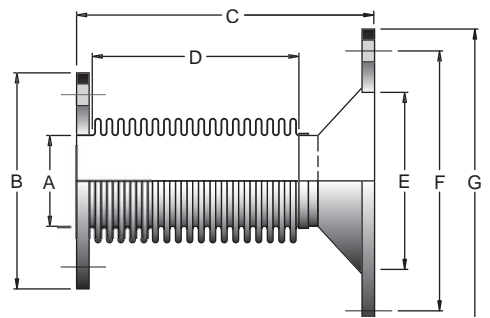

TYPE 12 - FLANGE X CONE INCREASER FLANGE

T-321 STAINLESS STEEL BELLOWS / FLEX
 125/150# ANSI CARBON STEEL INLET FLANGE
 T-321 STAINLESS STEEL CONE TRANSITION
 125/150# ANSI CARBON STEEL OUTLET FLANGE

OPTIONS:

- Longer / Shorter Lengths
- Inconel 625 Bellows
- Special Drilled / Metric Flanges
- Flow Liner
- Cummins and Detroit Flanges
- T-304 Stainless Steel Flanges

TYPE 12 - MULTI-PLY BELLOWS

INLET FLANGE				INCREASE OUTLET 1 SIZE				INCREASE OUTLET 2 SIZES			
A	B	C	D	E	F	G	PART NO.	E	F	G	PART NO.
3"	7.50	14.00	9.00	4"	7.50	9.00	12M0300-4-14	5"	9.00	10.00	12M0300-5-14
3.50"	8.50	14.00	9.00	4"	7.50	9.00	12M0350-4-14	5"	8.50	10.00	12M0350-5-14
4"	9.00	14.00	9.00	5"	8.50	10.00	12M0400-5-14	6"	9.50	11.00	12M0400-6-14
5"	10.00	14.00	9.00	6"	9.50	11.00	12M0500-6-14	8"	11.75	13.50	12M0500-8-14
6"	11.00	14.00	9.00	8"	11.75	13.50	12M0600-8-14	10"	14.25	16.00	12M0600-10-14
8"	13.50	14.00	9.00	10"	14.25	16.00	12M0800-10-14	12"	17.00	19.00	12M0800-12-14
10"	16.00	14.00	9.00	12"	17.00	19.00	12M1000-12-14	14"	18.75	21.00	12M1000-14-14
12"	19.00	14.00	9.00	14"	18.75	21.00	12M1200-14-14	16"	21.25	23.50	12M1200-16-14
14"	21.00	14.00	9.00	16"	21.25	23.50	12M1400-16-14	18"	22.75	25.00	12M1400-18-14
16"	23.50	14.00	9.00	18"	22.75	25.00	12M1600-18-14	20"	25.00	27.50	12M1600-20-14
18"	25.00	14.00	9.00	20"	25.00	27.50	12M1800-20-14	22"	27.25	29.50	12M1800-22-14
20"	27.50	14.00	9.00	22"	27.25	29.50	12M2000-22-14	24"	29.50	32.00	12M2000-24-14
22"	29.50	14.00	9.00	24"	29.50	32.00	12M2200-24-14	26"	31.75	34.25	12M2200-26-14
24"	32.00	14.00	9.00	26"	31.75	34.25	12M2400-26-14	30"	36.00	38.75	12M2400-30-14

TYPE 12 - SINGLE-PLY BELLOWS

INLET FLANGE				INCREASE OUTLET 1 SIZE				INCREASE OUTLET 2 SIZES			
A	B	C	D	E	F	G	PART NO.	E	F	G	PART NO.
3"	7.50	14.00	9.00	4"	7.50	9.00	12S0300-4-14	5"	9.00	10.00	12S0300-5-14
3.50"	8.50	14.00	9.00	4"	7.50	9.00	12S0350-4-14	5"	8.50	10.00	12S0350-5-14
4"	9.00	14.00	9.00	5"	8.50	10.00	12S0400-5-14	6"	9.50	11.00	12S0400-6-14
5"	10.00	14.00	9.00	6"	9.50	11.00	12S0500-6-14	8"	11.75	13.50	12S0500-8-14
6"	11.00	14.00	9.00	8"	11.75	13.50	12S0600-8-14	10"	14.25	16.00	12S0600-10-14
8"	13.50	14.00	9.00	10"	14.25	16.00	12S0800-10-14	12"	17.00	19.00	12S0800-12-14
10"	16.00	14.00	9.00	12"	17.00	19.00	12S1000-12-14	14"	18.75	21.00	12S1000-14-14
12"	19.00	14.00	9.00	14"	18.75	21.00	12S1200-14-14	16"	21.25	23.50	12S1200-16-14
14"	21.00	14.00	9.00	16"	21.25	23.50	12S1400-16-14	18"	22.75	25.00	12S1400-18-14
16"	23.50	14.00	9.00	18"	22.75	25.00	12S1600-18-14	20"	25.00	27.50	12S1600-20-14
18"	25.00	14.00	9.00	20"	25.00	27.50	12S1800-20-14	22"	27.25	29.50	12S1800-22-14
20"	27.50	14.00	9.00	22"	27.25	29.50	12S2000-22-14	24"	29.50	32.00	12S2000-24-14
22"	29.50	14.00	9.00	24"	29.50	32.00	12S2200-24-14	26"	31.75	34.25	12S2200-26-14
24"	32.00	14.00	9.00	26"	31.75	34.25	12S2400-26-14	30"	36.00	38.75	12S2400-30-14

TYPE 12 - FLEX HOSE

INLET FLANGE				INCREASE OUTLET 1 SIZE				INCREASE OUTLET 2 SIZES			
A	B	C	D	E	F	G	PART NO.	E	F	G	PART NO.
3"	7.50	21.00	17.00	4"	7.50	9.00	12F0300-4-21	5"	9.00	10.00	12F0300-5-21
3.50"	8.50	21.00	17.00	4"	7.50	9.00	12F0350-4-21	5"	8.50	10.00	12F0350-5-21
4"	9.00	21.00	17.00	5"	8.50	10.00	12F0400-5-21	6"	9.50	11.00	12F0400-6-21
5"	10.00	21.00	17.00	6"	9.50	11.00	12F0500-6-21	8"	11.75	13.50	12F0500-8-21
6"	11.00	21.00	17.00	8"	11.75	13.50	12F0600-8-21	10"	14.25	16.00	12F0600-10-21
8"	13.50	21.00	17.00	10"	14.25	16.00	12F0800-10-21	12"	17.00	19.00	12F0800-12-21
10"	16.00	21.00	17.00	12"	17.00	19.00	12F1000-12-21	14"	18.75	21.00	12F1000-14-21
12"	19.00	21.00	17.00	14"	18.75	21.00	12F1200-14-21	16"	21.25	23.50	12F1200-16-21
14"	21.00	21.00	17.00	16"	21.25	23.50	12F1400-16-21	18"	22.75	25.00	12F1400-18-21
16"	23.50	21.00	17.00	18"	22.75	25.00	12F1600-18-21	20"	25.00	27.50	12F1600-20-21
18"	25.00	21.00	17.00	20"	25.00	27.50	12F1800-20-21	22"	27.25	29.50	12F1800-22-21

DME INCORPORATED